



Netshield (Pty) Ltd.
Tijger Valley Office Park, Concept House,
10 Pony Street, Silver Lakes, Pretoria.

P.O. Box 1223, Wapadrand 0050

Telephone: +27(0)86 111-4428
+27(0)12 841-0320
Facsimile: +27 (0) 86 692-9643

PRODUCT BRIEF

Solar Battery and generator container

Container for solar batteries, generator and control system Recommended specifications

6 METER CONTAINER CONVERSION consist of:-

- Marine steel container 1 x 6,11 m (L) x 2,44 m (W) x 2,59 m (H)
- Surface, primed, painted internally & externally to customer colour requirements.
- 1 x Type A Transformer door .815mm w x 2.030mm h without Louvre (fitted with Mortice lockset or padlock mechanism)
- Type M Double Transformer door 1.525mm w x 2.135mm h without Louvers (fitted with Mortice lockset or padlock mechanism) to Front end panel
- 2 x 100mm doublesided Chromodek partition walls with 100mm polystyrene insulation.
- Insulation for complete interior including containers doors using 100mm polystyrene laminated to 0.5mm Chromodek paneling.
- 6 x 300 x 300mm aluminium louvers
- 2 x 1200 x 1200mm aluminium louvers
- 1 x 300 x 300 single phase extraction fan
- Rubberised flooring
- 6 x washable filters
- Container is wind and water tight condition

Container Top View

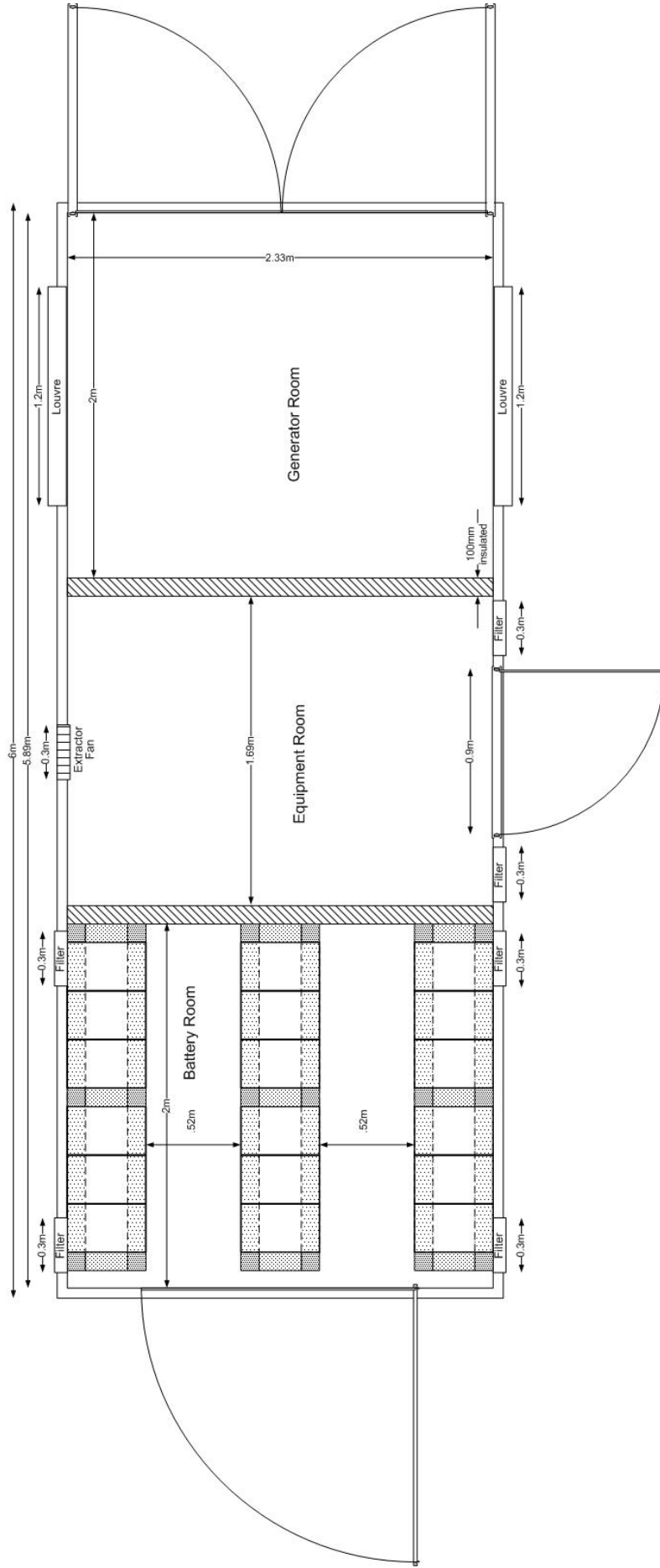

Container Side View 1

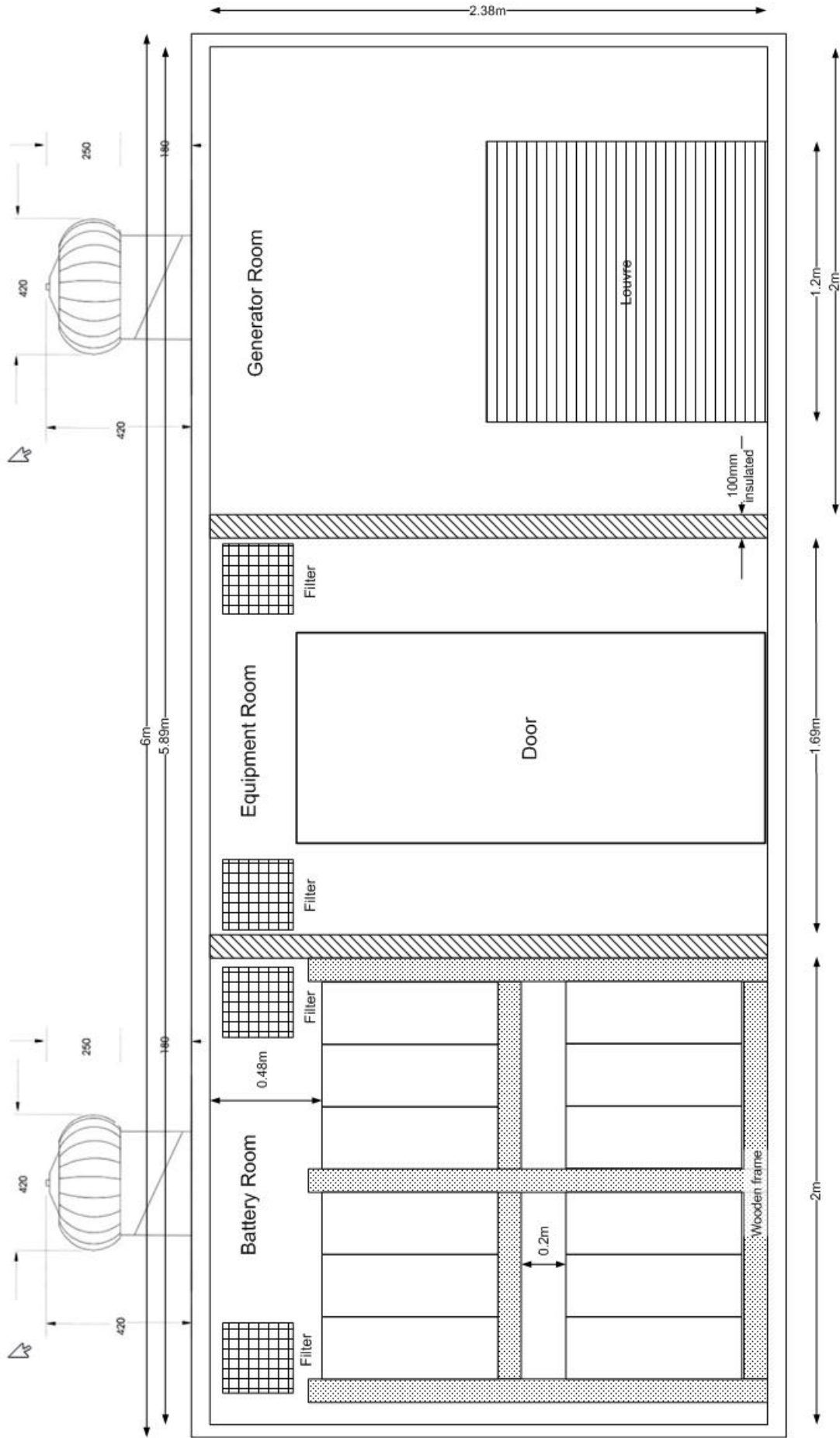

Container Side View 2

